

SKYSOL POWERED ROOFBLIND

ORDER FORM GUIDE



27/08/2020

1

Mobile living made easy.

 **DOMETIC**

SKYSCREEN POWERED

Window Info
Location _____
Window ID _____
Quantity Required _____

Dometic number blinds using the following method to identify the **Location** (number) of the windows (see below). The naming below can also be used for the **Window ID**. A photograph of the window recess submitted with the order is also helpful to ensure correct design and operation of the blind.

Also enter the **Quantity Required** if you need a number of identical blinds. If you need different options use different sections.

WARNING: Powered blinds should NOT be used in front of, or below Emergency Exits.

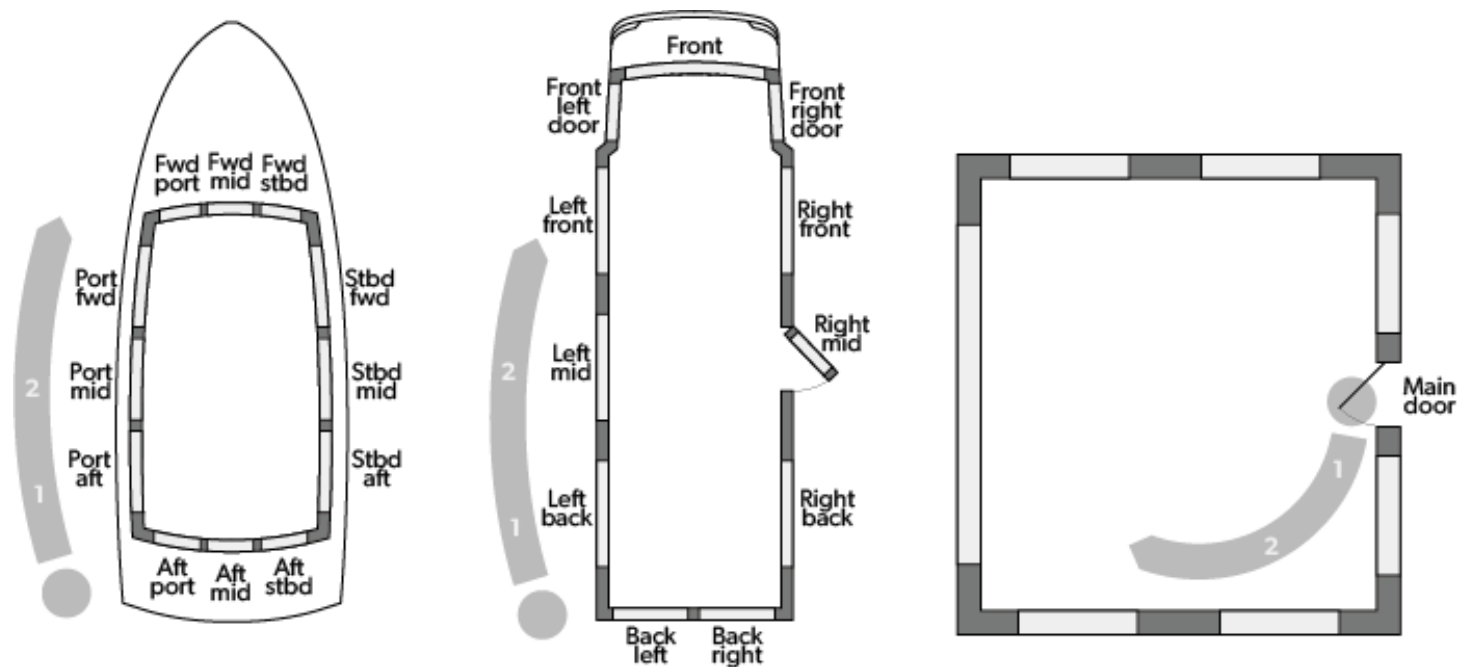

SKYSOL POWERED ROOFBLIND

Dimension	
Aperture (X / Y)	<input type="checkbox"/>
Overall (X / Y)	<input type="checkbox"/>

Aperture (X / Y)
Define the blind using the internal aperture size. The stack will affect the overall size of the blind.

Overall (X / Y)
Define the blind using the overall size of the product. The stack will affect the aperture size of the blind.

If you need to size the overall blind size to fit into an existing RECESS then allow 4mm overall clearance between the blind size and the recess size to allow for blind build tolerances.

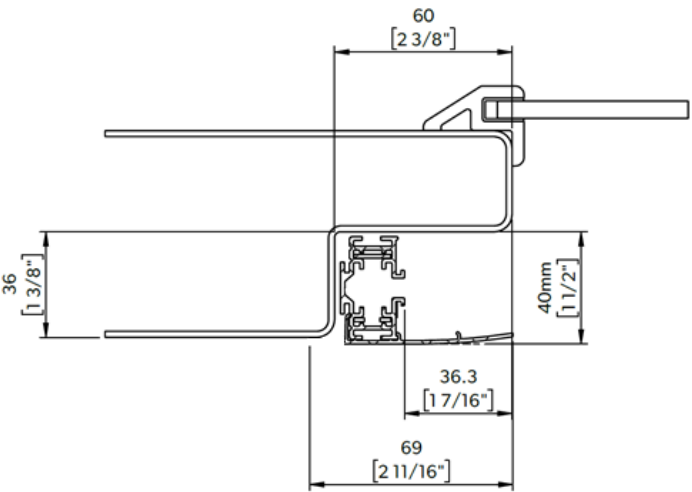
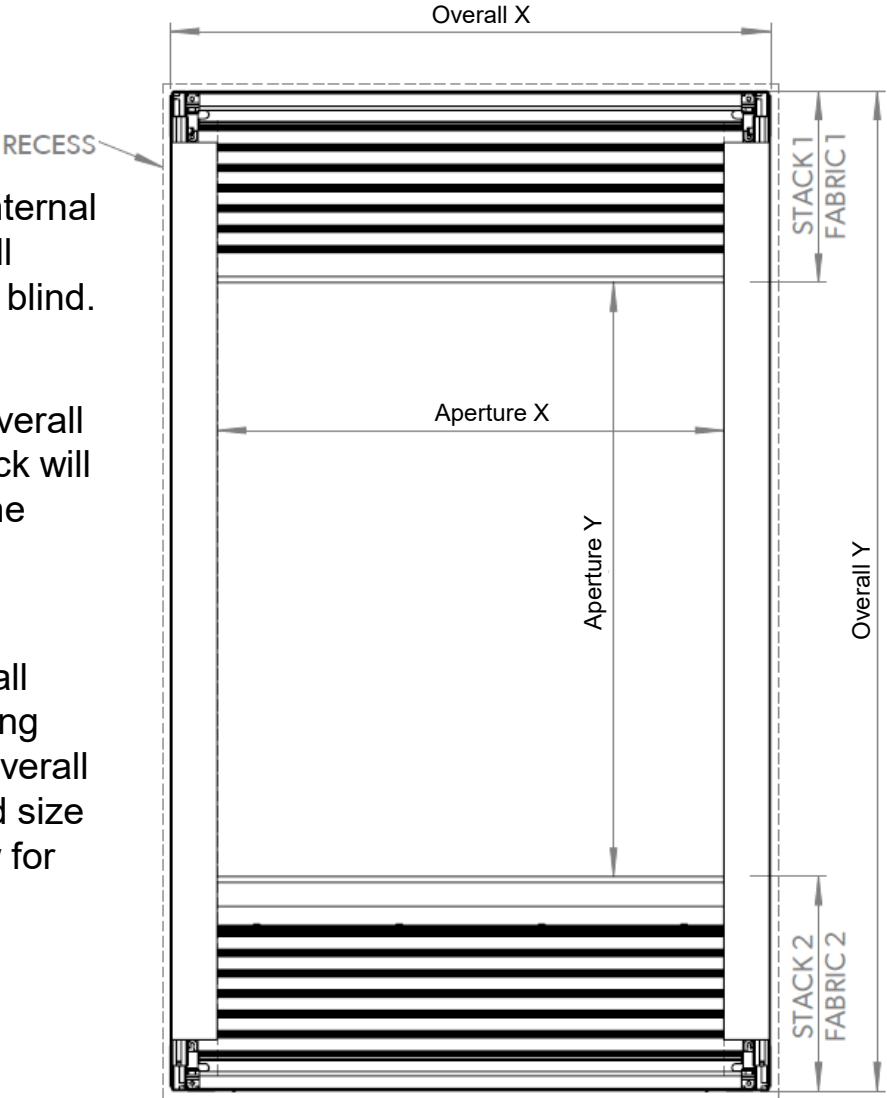

Sidetrack section

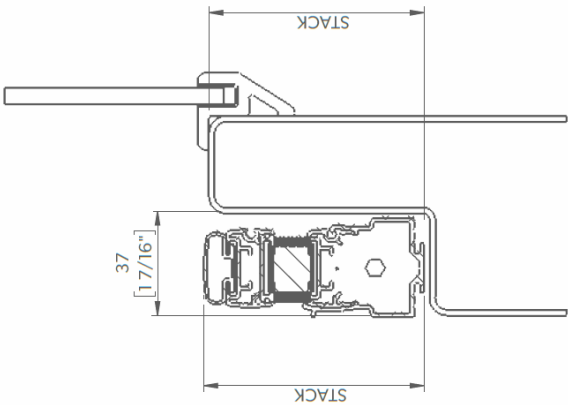

Headrail section

SKYSOL POWERED ROOFBLIND

Dimension	
Aperture (X / Y)	<input type="checkbox"/>
Overall (X / Y)	<input type="checkbox"/>

NOTE - If you specify the Aperture (X / Y) then the panels will be equally spaced within the visible opening (or aperture) and an adjustment will be made to the first panel to allow for this (See 'Fabric offset'). If you specify the Overall (X / Y) then each fabric panel will be the same size. This could mean that the panels are not equally spaced within the aperture (See 'Equal panels').

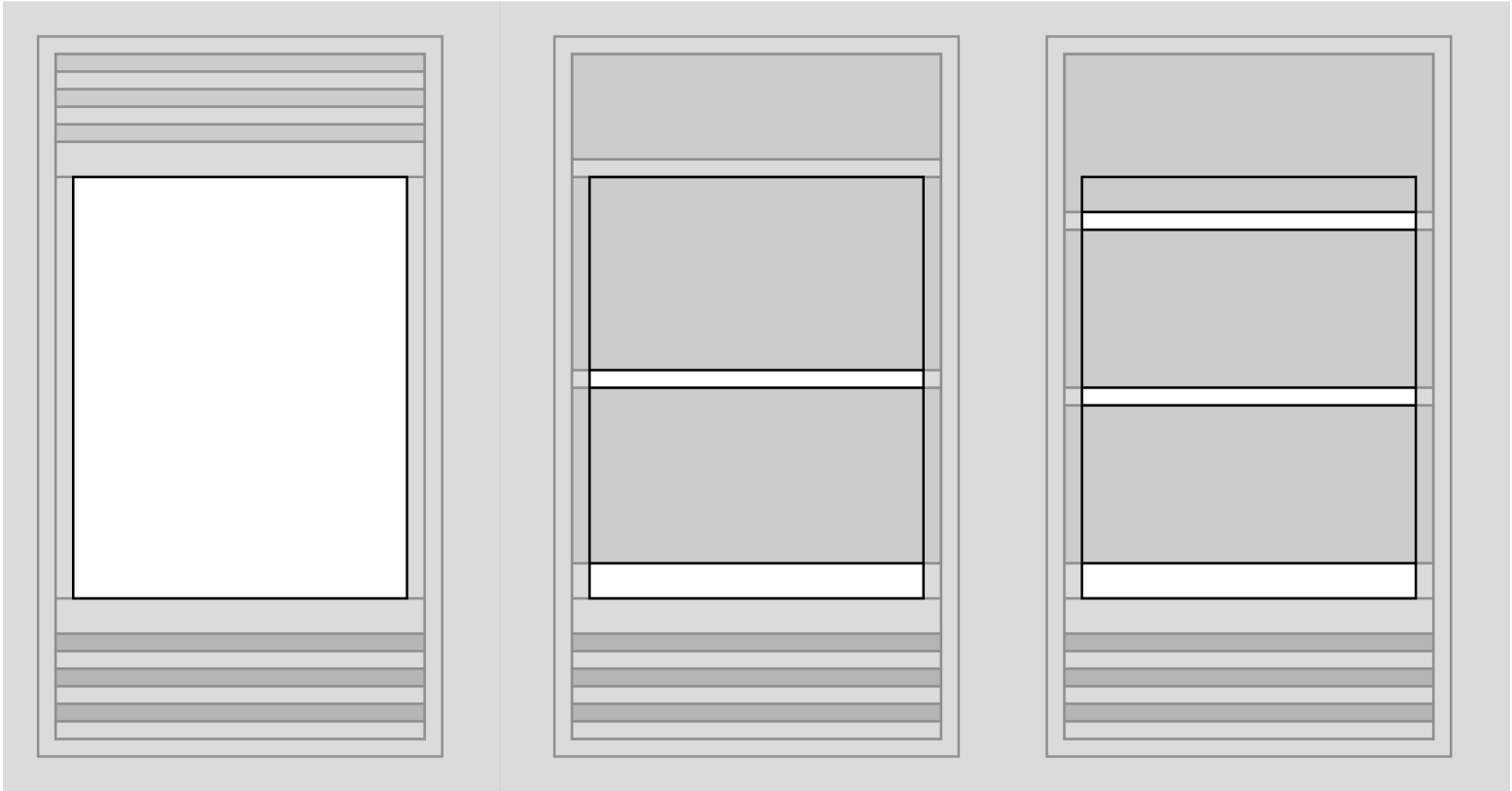

Stowed blind

Fabric offset
Equal panels in aperture

Equal panels
Equal panels in blind

SKYSOL POWERED ROOFBLIND

Dimension
Width
_____ mm
Drop
_____ mm

Note: When measuring to fit into a RECESS include an allowance for any radius in the corners of the RECESS. This product has square corners.

Note the minimum and maximum available:

Min. Width Overall (X)	725
Max. Width Overall (X)	2000 flyscreen - 2500 honeycomb
Min. Drop Overall (Y)	350
Max. Drop Overall (Y)	3500

Contact Dometic Blinds for further information

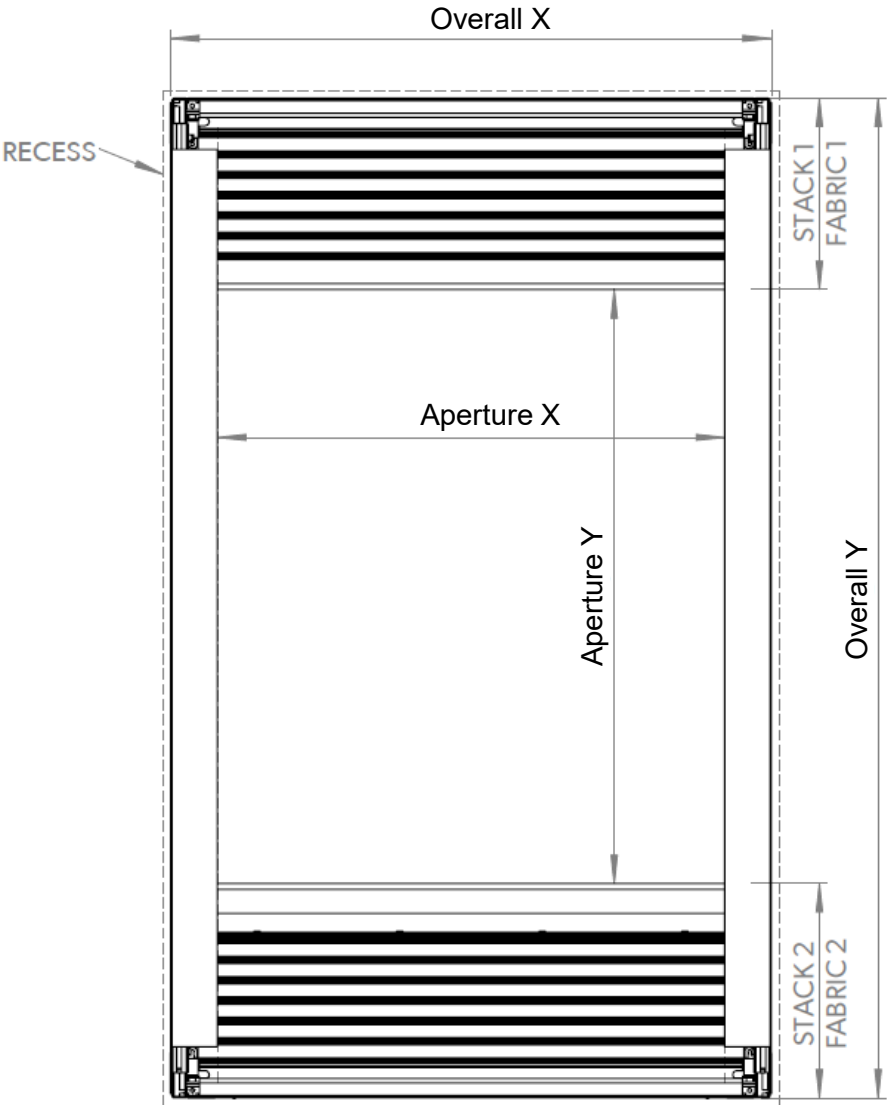

SKYSOL POWERED ROOFBLIND

Blind Type	
Format	
DM	<input type="checkbox"/>
D2	<input type="checkbox"/>
S0	<input type="checkbox"/>
S1	<input type="checkbox"/>
S2	<input type="checkbox"/>

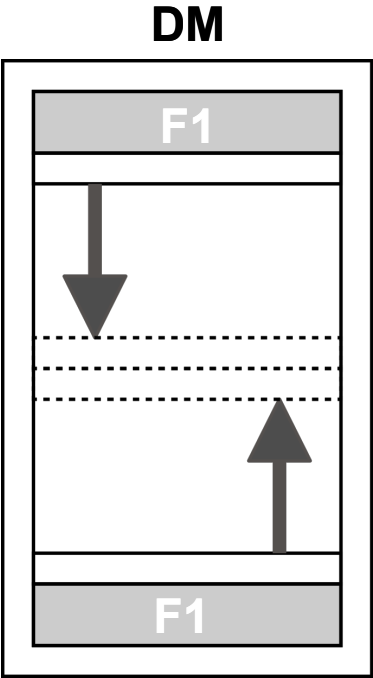

DOUBLE ENDED MEET IN THE MIDDLE WITH THE SAME FABRIC AT EACH END

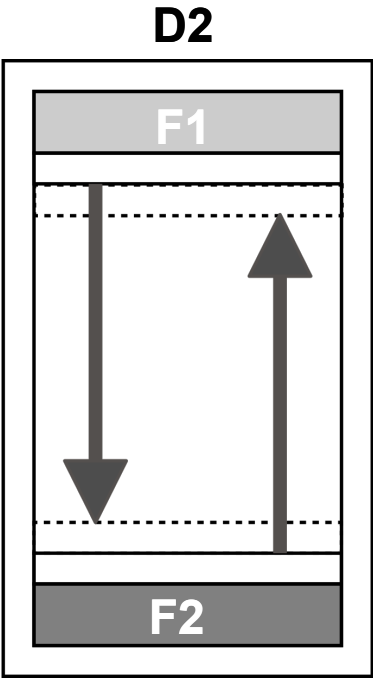

DOUBLE ENDED FULL TRAVEL WITH A DIFFERENT FABRIC AT EACH END

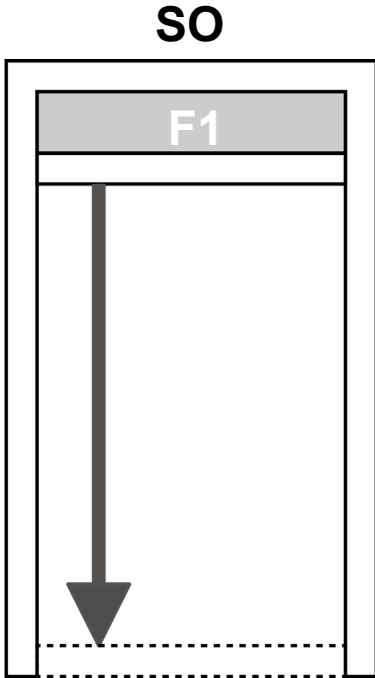

OPEN ENDED WITH A SINGLE FABRIC AT THE CLOSED END

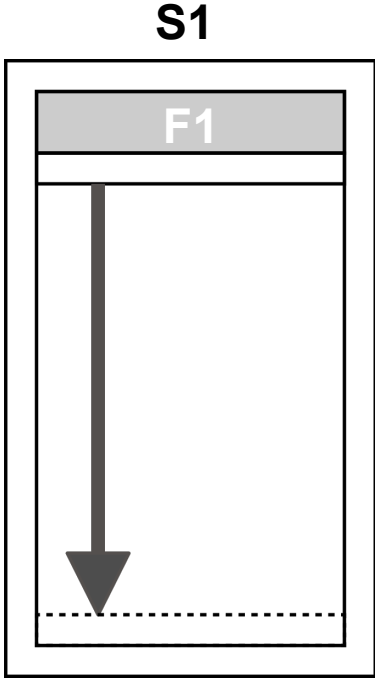

SINGLE ENDED WITH A SINGLE FABRIC AT ONE END

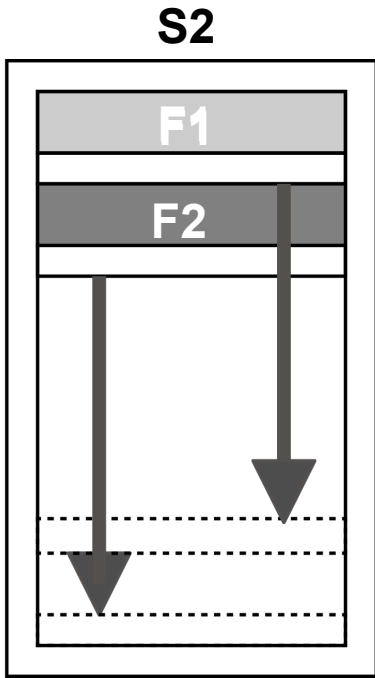

SINGLE ENDED WITH TWO FABRICS WHICH BOTH STOW AT THE SAME END

SKYSOL POWERED ROOFBLIND

Blind Type	
Motor Choice	
12vDC	<input type="checkbox"/>
24vDC	<input type="checkbox"/>

We are currently offering a 12v or 24v DC motor drive. These are our double-ended low noise motors. If necessary on particularly large blinds more that motor might be used in parallel to drive the blind.

A Somfy motor option might be available soon.

ATLANTIC 12S



12vDC

ATLANTIC 24S



24vDC

SKYSOL POWERED ROOFBLIND

Fabric
Fabric 1 (Code) _____
Fabric 2 (If D2 / S2) (Code) _____

Specify the type and location of the fabric/s for your blind – note the position of Fabric 1 (F1) and Fabric 2 (F2) on the drawings below.

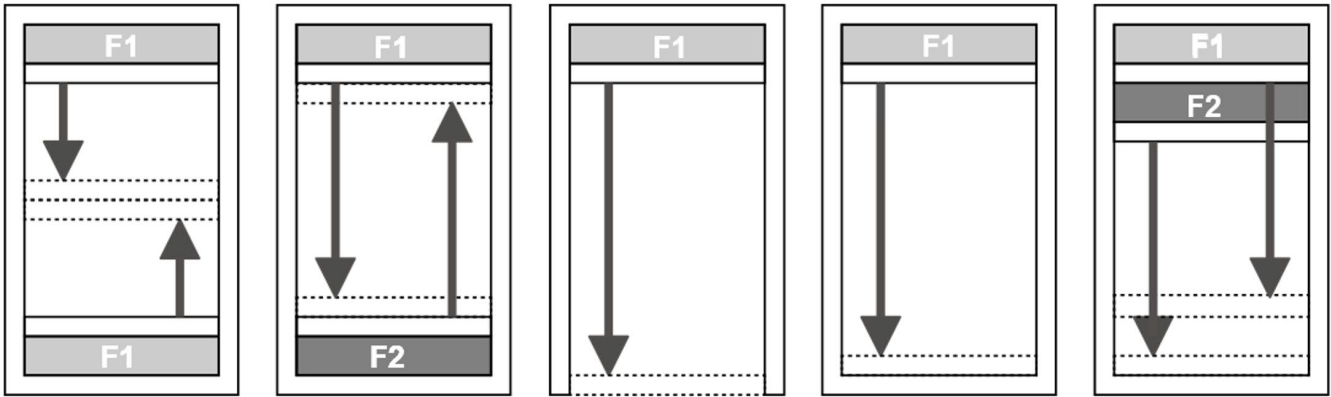

Standard Fabrics

- FLS-P020 Flyscreen black
- H25-BWH Honeycomb 25mm blackout white
- H25-BWH Honeycomb 25mm blackout black / white
- H25-PWH Honeycomb 25mm privacy white

These are a few popular fabrics. For other fabric & colour options contact Dometic Blinds



SKYSOL POWERED ROOFBLIND

Align with Aperture

Fabric 1 Offset

☐

Drop (If Yes)

(If aperture dimension given, not needed)

Fabric 2 Offset

☐

(If DM / D2 / S2)

Drop (If Yes)

(If aperture dimension given, not needed)

NOTE ON PANEL SIZES

The default drop for each panel varies depending on the width of the blind. As a guide the list below shows what ranges you can expect to see.

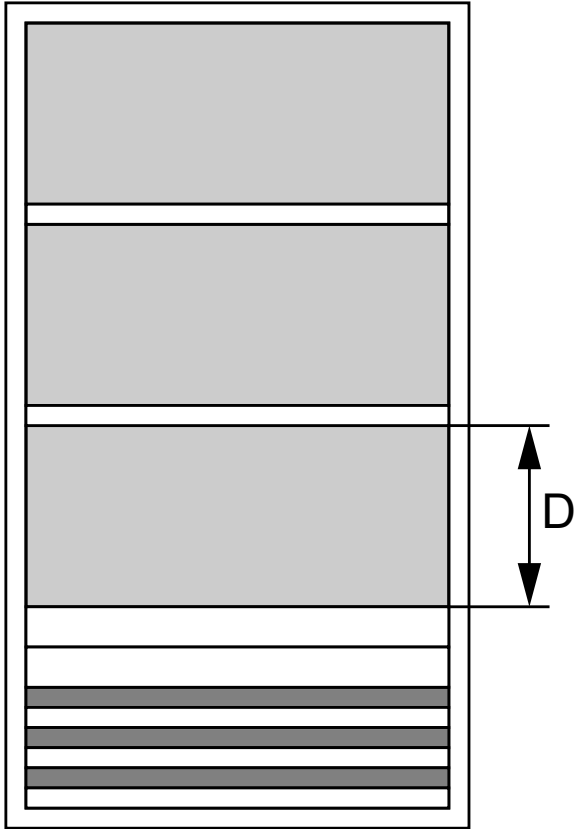

Width (mm)	D - Panel Drop (mm)
507 to 1072	<= 300
1073 to 1342	301 to 375
1343 to 2384	376 to 450

SKYSOL POWERED ROOFBLIND

Side Tracks	
Straight	<input type="checkbox"/>
Curved	<input type="checkbox"/>
Radius	
Special	<input type="checkbox"/>
Drawing Reference	

Straight

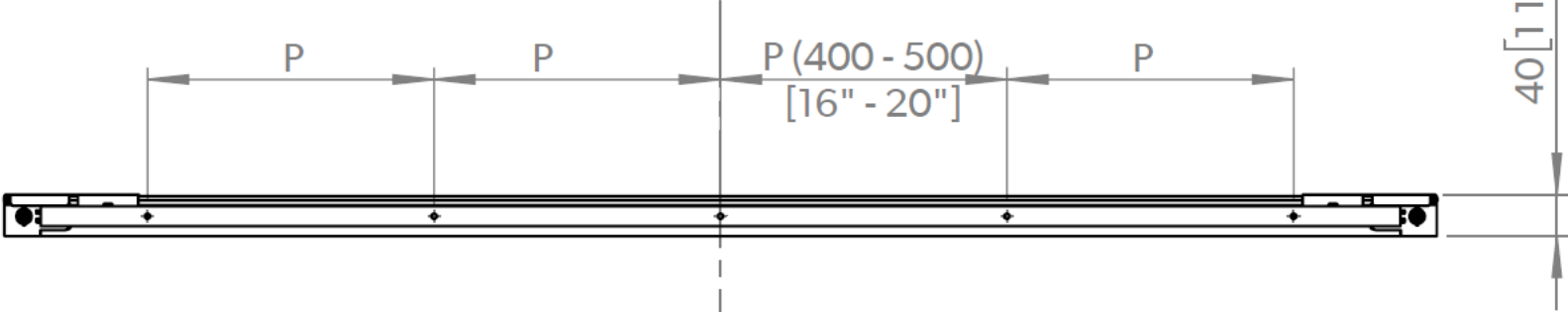

Curved – At additional cost

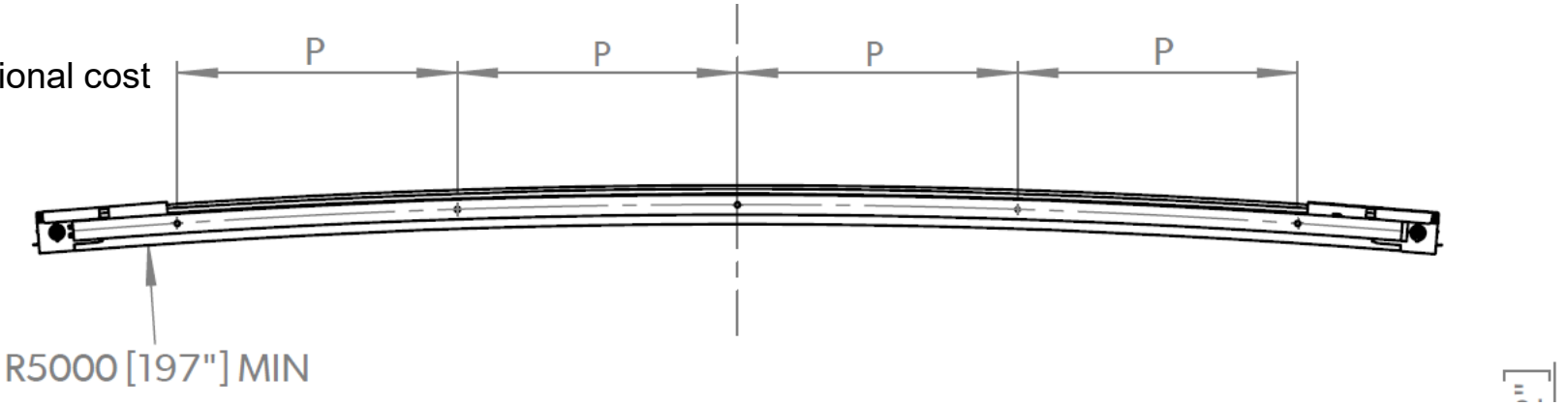

Special – At additional cost - Special is for a side track that is curved but not a simple arc. A special side track can be a combination of a straight and a curve or multiple curves (as long as the minimum radius if 5000mm). A drawing will be required. Please contact Dometic Blinds with your requirements or for further information.

SKYSOL POWERED ROOFBLIND

Hardware Colour	
Standard	Custom
Frame, Mid/ Moving Rail and Buffer	Frame
White <input type="checkbox"/>	White <input type="checkbox"/>
Black <input type="checkbox"/>	Black <input type="checkbox"/>
	Custom (RAL) <input type="checkbox"/>
	<hr/>
	Mid/Moving Rail
	White <input type="checkbox"/>
	Black <input type="checkbox"/>
	Custom (RAL) <input type="checkbox"/>
	<hr/>
	Buffer
	White <input type="checkbox"/>
	Black <input type="checkbox"/>

Frame, Mid Rails and Moving Rails can be custom painted (at extra cost)
Custom Coloured Buffers are available (but at a huge extra cost and long lead time and so only really suitable for large contracts).
All plastic components are supplied in white, however, they are not visible once installed correctly.

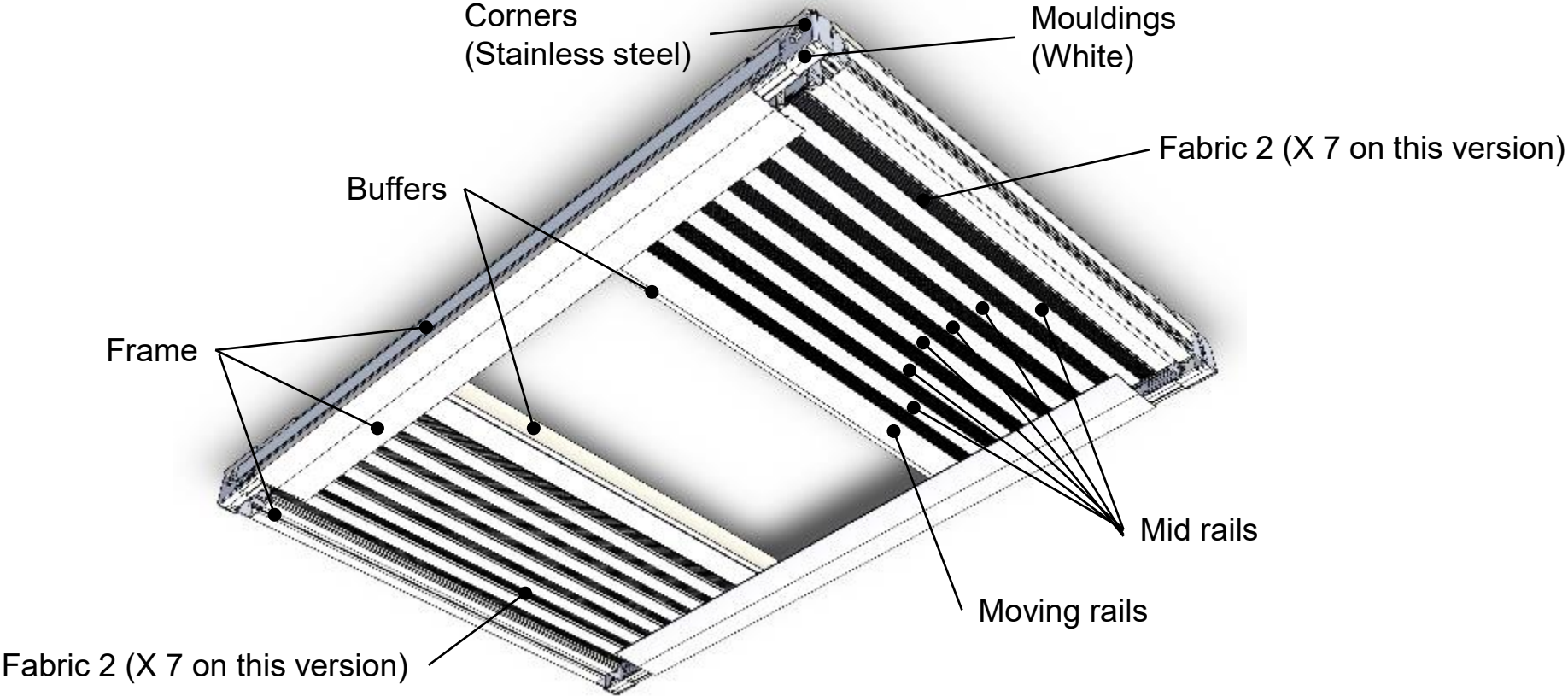

Note : All plastic components are supplied in white, however, they are not visible once installed correctly

SKYSOL POWERED ROOFBLIND

Control	
Integrated to Existing Switch (No Hardware Supplied)	<input type="checkbox"/>
AP Remote (Complete Seperate Order Form)	<input type="checkbox"/>

Integrated to Existing Switch
No controllers required (blind will be hard wired to switches)



AP Remote
Blind will be controlled using 1 or more AP Remote Controllers (blind will be supplied with the required number of radio receivers – these need to be fitted close to the blind)



SKYSOL POWERED ROOFBLIND

Packing

Flat Pack ☐
Assembled ☐
(In Crate)

Flat Packed

Blind is assembled and tested and then broken down into sub-assemblies for assembly on-site (using the Installation & Operating Instructions available from the Dometic Website).

Assembled

The blind will be shipped fully assembled. In most cases this will require a shipping crate (at extra cost).

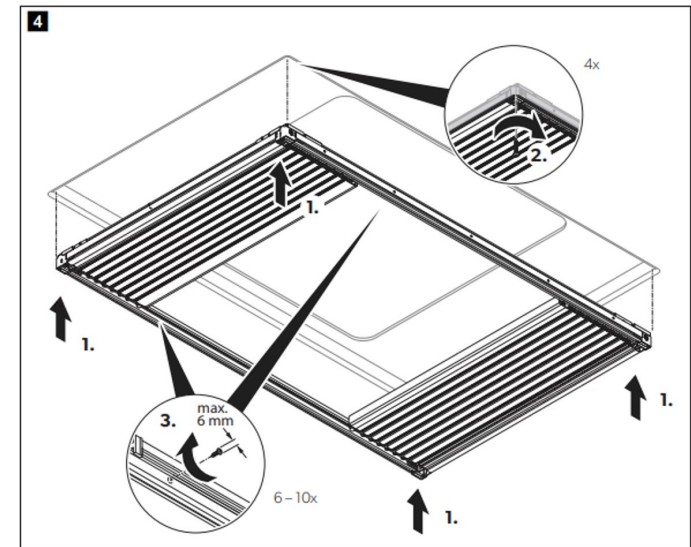
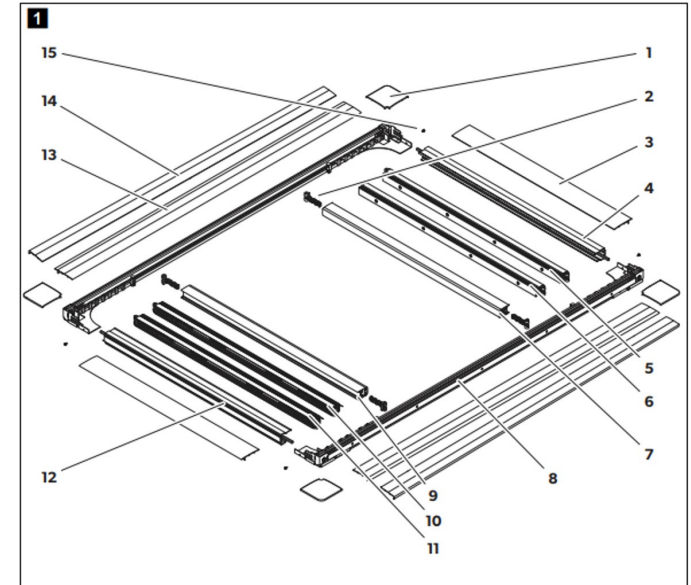

2110012020

13

SKYSOL POWERED ROOFBLIND

Customised (If Applicable)	
Panel Assembly Only	Drawing Required <input type="checkbox"/>
Fabric 1 <input type="checkbox"/>	(Enter Drawing/ Template Reference)
Fabric 2 (If S2 / D2) <input type="checkbox"/>	
Side Track Assembly <input type="checkbox"/>	

The customised section is for options not covered or for spares which need to be configured.

Panel Assembly Only

Use this section if you need to order replacement fabric panels for an existing blind. You will still need to fill in the rest of the order form to make sure the panels fit.



Side Track Assembly

Use this section to order replacement side tracks.

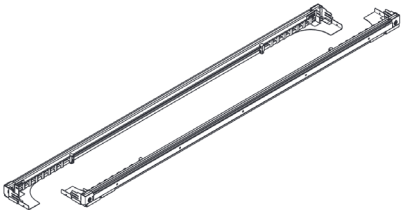

A scenic coastal road with a white motorhome and cyclists. The road is winding along a cliffside, with the ocean visible in the background. The sky is blue with some clouds. The text is overlaid on the image.

↗ DOMETIC MOBILE LIVING MADE EASY.

Mobile living made easy.

↗ DOMETIC